

FULL CLOSURE
STEPHENS ST SW:
FROM WINDSOR ST SW
TO IRA ST SW
(450 FT)

PARKING LANE CLOSURE
WEST CURB PARKING LANE
OF GIRABALDI ST SW:
FROM BASS ST SW TO
STEPHENS ST SW (400 FT)

PARKING LANE CLOSURE
EAST CURB PARKING LANE
OF GIRABALDI ST SW: B/T
STEPHENS ST SW &
BASS ST SW (200 FT)



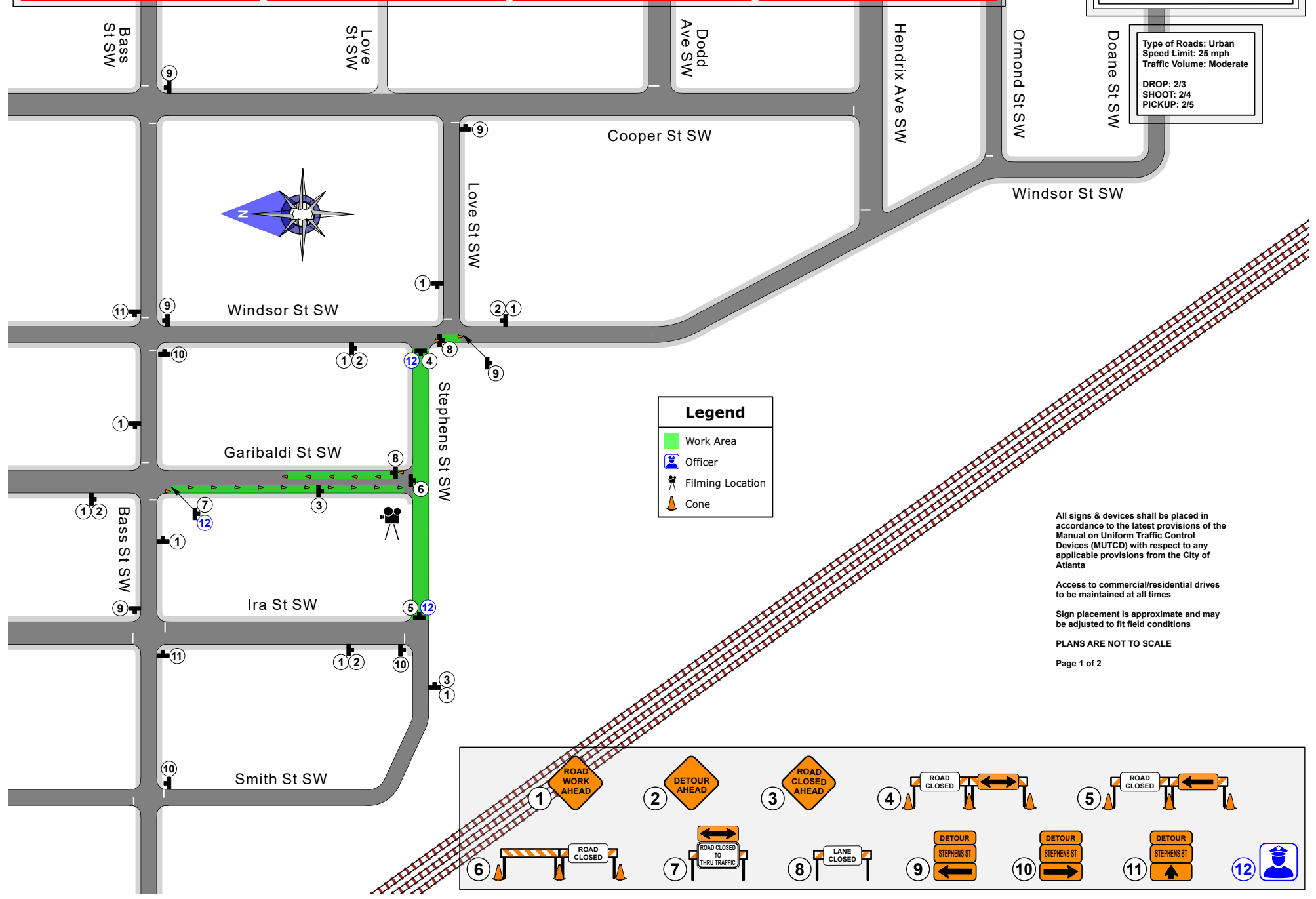

PARKING LANE CLOSURE
WEST CURB PARKING LANE
OF WINDSOR ST SW: FROM
STEPHENS ST SW TO
LOVE ST SW (50 FT)

 Southeastern Traffic Supply, Inc.
 1500 Veterans Memorial Hwy SE
 Mableton, GA 30126
 404.989.2441
 Date: 1/28/19 Draft: 1
 Design: W.W. Thompson (c): 706.254.1919
 Project: "Puget Sound"
 Customer: Universal Television, LLC

Type of Roads: Urban
 Speed Limit: 25 mph
 Traffic Volume: Moderate
 DROP: 2/3
 SHOOT: 2/4
 PICKUP: 2/5



Legend

-  Work Area
-  Officer
-  Filming Location
-  Cone

All signs & devices shall be placed in accordance to the latest provisions of the Manual on Uniform Traffic Control Devices (MUTCD) with respect to any applicable provisions from the City of Atlanta

Access to commercial/residential drives to be maintained at all times

Sign placement is approximate and may be adjusted to fit field conditions

PLANS ARE NOT TO SCALE

Page 1 of 2

DETOUR ROUTES

	Southeastern Traffic Supply, Inc. 5529 Oakdale Rd SE Mableton, GA 30126 404.989.2441
	Date: 1/28/19 Draft: 1 Design: Walter W. Thompson (c:) 706.254.1919 Project: 'Puget Sound' Customer: Universal Television, LLC

**FULL CLOSURE
STEPHENS ST SW:
FROM WINDSOR ST SW
TO IRA ST SW
(450 FT)**

SOUTHBOUND WINDSOR ST SW

1. CONTINUE on Windsor St SW
2. Turn LEFT onto Love St SW
3. Turn LEFT onto Cooper St SW
4. Turn LEFT onto Bass St SW
4. Turn LEFT onto Ira St SW

**NORTHBOUND WINDSOR ST SW/
WESTBOUND LOVE ST SW**

1. Turn RIGHT/CONTINUE on Windsor St SW
2. Turn LEFT onto Bass St SW
3. Turn LEFT onto Ira St SW

EASTBOUND STEPHENS ST SW

1. Turn LEFT onto Ira St SW
2. Turn RIGHT onto Bass St SW
3. Turn RIGHT onto Windsor St SW

SOUTHBOUND IRA ST SW

1. Turn RIGHT onto Stephens St SW
2. Turn RIGHT onto Bass St SW
3. Turn RIGHT onto Windsor St SW

All signs & devices shall be placed in accordance to the latest provisions of the Manual on Uniform Traffic Control Devices (MUTCD) with respect to any applicable provisions from the City of Atlanta

Access to commercial/residential drives to be maintained at all times

Sign placement is approximate and may be adjusted to fit field conditions

PLANS ARE NOT TO SCALE