

Legend

- Cone
- Vertical Face Panel
- Work Area

① ROAD WORK AHEAD

② LANE CLOSED

③ POLICE OFFICER

④ ROAD WORK AHEAD

④ LEFT LANE CLOSED AHEAD

④ NARROWING AHEAD

⑤ CURVE AHEAD

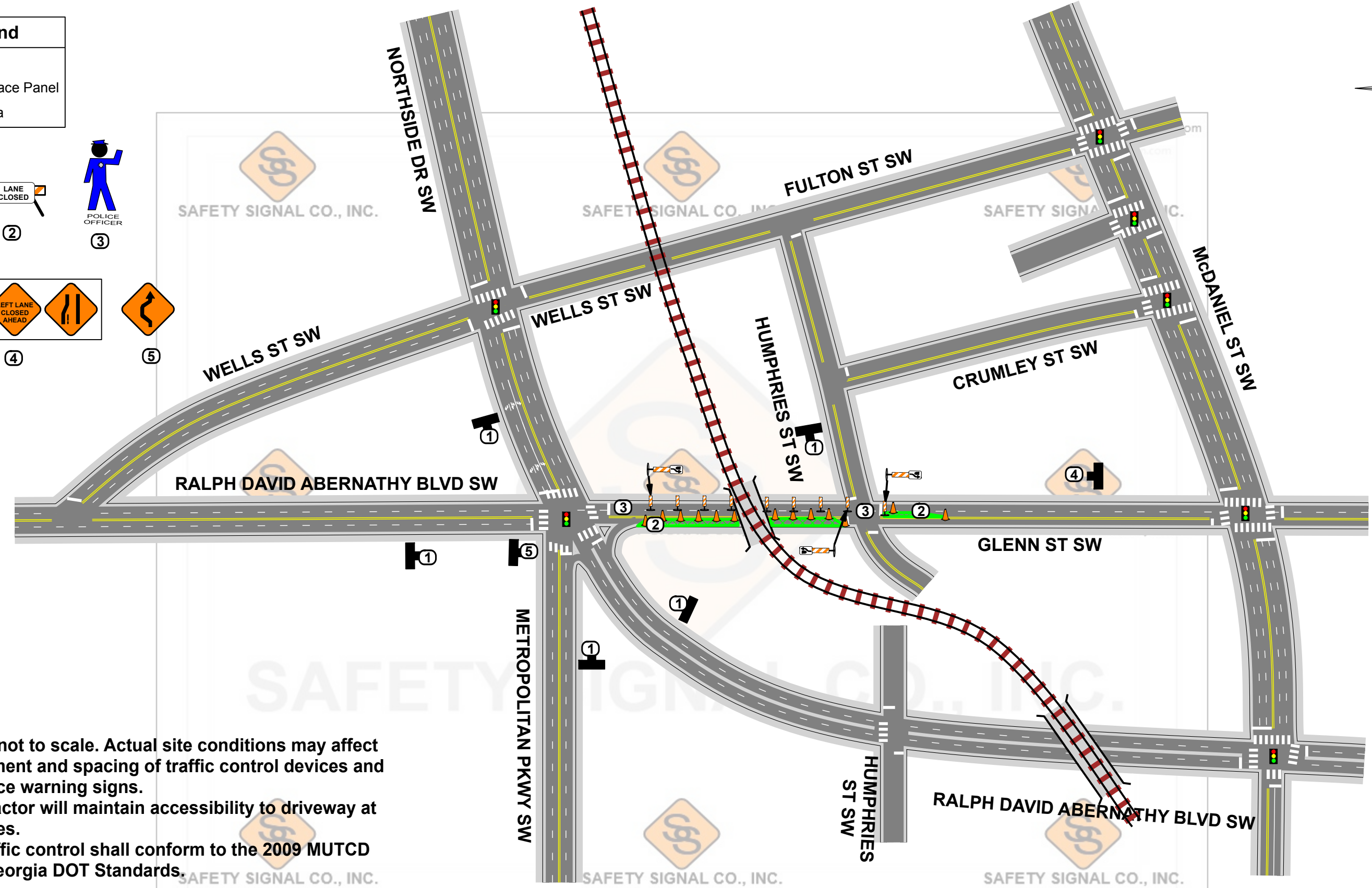

- NOTE:**
1. Plans not to scale. Actual site conditions may affect placement and spacing of traffic control devices and advance warning signs.
 2. Contractor will maintain accessibility to driveway at all times.
 3. All traffic control shall conform to the 2009 MUTCD and Georgia DOT Standards.

955 FT WORK AREA

**GLENN ST SW
SOUTH CURB LANE CLOSURE
BETWEEN HUMPHRIES ST SW
AND METROPOLITAN PKWY SW**

**AMBIENT SOUND PRODUCTIONS, LLC
"STARGIRL" SEASON 1**
3700 Atlanta Industrial Pkwy CT
Atlanta, Georgia 30313
Office: 404-900-7819

 **SAFETY SIGNAL CO., INC.**
P.O. BOX 488
UNION CITY, GEORGIA 30291
OFFICE: 770/964-3181 FAX: 770/964-4005
Drawn by: CT White Date: 04-29-19